

Accessori Accessories

**A**



WIMOD

Trasmissione **WIRELESS**  
WIRELESS transmission

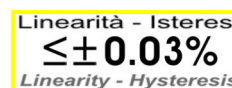

**OPZIONE** II 2G Ex ib IIC T6 Gb  
**OPTION** II 2D Ex ib IIIC T70°C Db  
Certificate: TÜV CY 18 ATEX 0206102 X

Interamente saldata al LASER  
Completely LASER welded

SOLLECITAZIONI DINAMICHE  
DYNAMIC STRESSES

Dimensioni Dimensions

[mm]

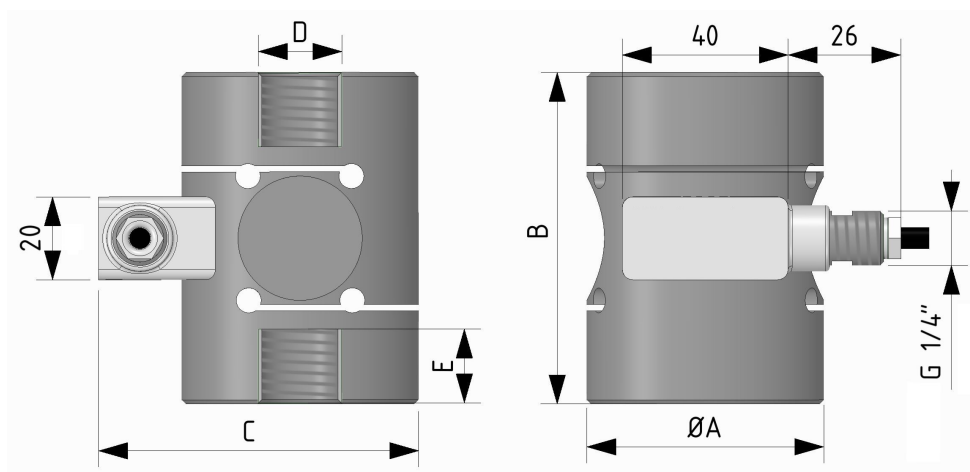

| CODE                     | LOAD   | ØA | B   | C    | D       | E  |
|--------------------------|--------|----|-----|------|---------|----|
| CTCE57350K5              | 350 kg | 57 | 80  | 74.5 | M20X1.5 | 17 |
| CTCE57500K5              | 500 kg |    |     |      |         |    |
| CTCE571TK5               | 1 t    |    |     |      |         |    |
| CTCE572T55               | 2.5 t  |    |     |      |         |    |
| CTCE575T5 <sup>(1)</sup> | 5 t    |    |     |      |         |    |
| CTCE825T5                | 5 t    | 82 | 110 | 102  | M30X2   | 20 |
| CTCE827T55               | 7.5 t  |    |     |      |         |    |
| CTCE8210T5               | 10 t   |    |     |      |         |    |
| CTCE8220T5               | 20 t   |    |     |      |         |    |

**Dati Tecnici**
**Technical Data**



|   |   |   |
|---|---|---|
| CARICO NOMINALE   | NOMINAL LOAD  | 350 - 500 kg<br>1 - 2.5 - 5 <sup>(1)</sup> t<br>7.5 -10 -20 t                                     |
| SENSIBILITA' NOMINALE<br>TOLLERANZA DI CALIBRAZIONE   | NOMINAL SENSITIVITY<br>SENSITIVITY TOLERANCE  | 2 mV/V<br>≤ ± 0.1 %   |
| EFFETTO TEMPERATURA (10 °C)<br>a) sullo zero<br>b) sulla sensibilità  | TEMPERATURE EFFECT (10 °C)<br>a) on zero<br>b) on sensitivity   | ≤ ± 0.030 %<br>≤ ± 0.011 %  |
| LINEARITA'<br>ISTERESI<br>RIPETIBILITA'   | LINEARITY<br>HYSTERESIS<br>REPEATABILITY  | ≤ ± 0.03 %<br>≤ ± 0.03 %<br>≤ ± 0.01 %  |
| RESISTENZA DI INGRESSO<br>RESISTENZA DI USCITA<br>RESISTENZA DI ISOLAMENTO<br>BILANCIAMENTO DI ZERO<br>ALIMENTAZIONE DI RIFERIMENTO<br>ALIMENTAZIONE NOMINALE<br>ALIMENTAZIONE MAX.   | INPUT RESISTANCE<br>OUTPUT RESISTANCE<br>INSULATION RESISTANCE<br>ZERO BALANCE<br>RECOMMENDED SUPPLY VOLTAGE<br>NOMINAL SUPPLY VOLTAGE<br>MAXIMUM SUPPLY VOLTAGE  | 440 ± 20 Ω<br>350 ± 2Ω<br>>5 GΩ<br>≤ ±1 %<br>10 V<br>1 - 15 V<br>18 V                             |
| VALORI MECCANICI LIMITE RIFERITI<br>AL CARICO NOMINALE:<br>a) carico di servizio<br>b) carico limite<br>c) carico di rottura<br>d) massimo carico trasversale<br>e) carico dinamico limite<br>FRECCIA MAX. AL CARICO NOMINALE | MECHANICAL LIMIT VALUES<br>REFERRED TO NOMINAL LOAD:<br>a) service load<br>b) max permissible load<br>c) breaking load<br>d) max transverse load<br>e) max permissible dynamic load<br>DISPLACEMENT AT NOMINAL LOAD | 120 %<br>150 %<br>> 300 %<br>50 %<br>50 %<br>~ 0.3 mm   |
| TEMPERATURA DI RIFERIMENTO<br>CAMPO NOMINALE DI TEMPERATURA<br>TEMPERATURA DI ESERCIZIO<br>TEMPERATURA DI STOCCAGGIO  | REFERENCE TEMPERATURE<br>TEMPERATURE NOMINAL RANGE<br>SERVICE TEMPERATURE<br>STORAGE TEMPERATURE  | +23 °C<br>-10 / +40 °C<br>-20 / +70 °C<br>-20 / +80 °C  |
| PESO da 350 kg a 5 t (Ø57)<br>PESO da 5 t a 10 t (Ø82)<br>PESO 20t (Ø82)<br>CLASSE DI PROTEZIONE (EN 60529)<br>MATERIALE DELLA CELLA<br>LUNGHEZZA CAVO  | WEIGHT from 350 kg to 5 t (Ø57)<br>WEIGHT from 5 t to 10 t (Ø82)<br>WEIGHT 20 t (Ø82)<br>PROTECTION CLASS (EN 60529)<br>EXECUTION MATERIAL<br>CABLE LENGTH  | ~ 1.5 kg<br>~ 4.2 kg<br>~ 5 kg<br>IP67<br>Acciaio Inox / Stainless Steel<br>5 m (on request 10 m) |



<sup>(1)</sup> La cella di carico **5t Ø57** viene garantita in **TRAZIONE** fino a **2.5t**

The load cell **5t Ø57** is guaranteed in **TENSION** up to **2.5t**.

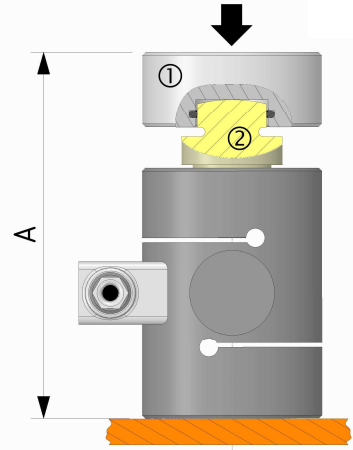
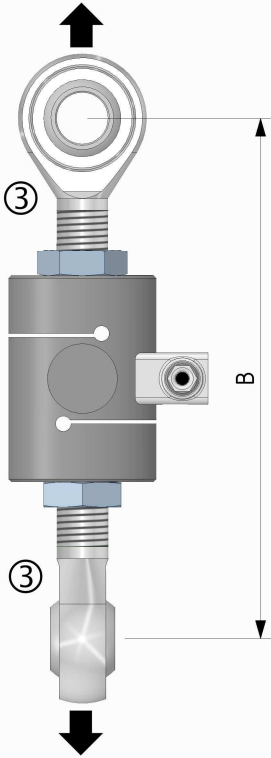
## Applicazioni Applications

| COMPRESSIONE <i>COMPRESSION</i>   | TRAZIONE <i>TENSION</i>   |
|---|---|
|  <p style="text-align: center;"> <b>TCE 350kg, 500kg, 1t, 2.5t, 5t</b>    <b>A = 117 mm</b><br/> <b>TCE 5t, 7.5t, 10t</b>                    <b>A = 149 mm</b><br/> <b>TCE 20t</b>                                    <b>A = 198 mm</b> </p> |  <p style="text-align: center;"> <b>TCE 350kg, 500kg, 1t, 2.5t</b>    <b>B = ~200mm</b><br/> <b>TCE 5t, 7.5t, 10t</b>                    <b>B = ~300mm</b><br/> <b>TCE 20t</b>                                    <b>B = ~420mm</b> </p> |
| <p><b>ATTENZIONE:</b></p> <p>Il peso del cavo può influire la misura, è pertanto consigliabile posizionarlo nella zona fissa dalla parte opposta al carico.</p>   | <p><b>WARNING:</b></p> <p><i>Cable weight can influence measurement, it is therefore recommended to place it at the opposite site of the load.</i></p>  |

## Accessori Accessories





| TCE:                         | CODE:    |   | ACCESSORIES (optional):        | ACCESSORI (opzionali):   |
|------------------------------|----------|---|--------------------------------|--------------------------|
| 350kg, 500kg<br>1t, 2.5t, 5t | CTIC22   | ① | <i>Loading head.</i>           | Testa di carico          |
|                              | CTS25M20 | ② | <i>Spherical loading head.</i> | Testa di carico sferica. |
|                              | CACCEM20 | ③ | <i>Knuckle joints.</i>         | Teste a snodo sferico    |
| 5t, 7.5t, 10t                | CTIC28   | ① | <i>Loading head.</i>           | Testa di carico          |
|                              | CTS45M30 | ② | <i>Spherical loading head.</i> | Testa di carico sferica. |
|                              | CACCEM30 | ③ | <i>Knuckle joints.</i>         | Teste a snodo sferico    |
| 20 t                         | CTIC35   | ① | <i>Loading head.</i>           | Testa di carico          |
|                              | CTS62M42 | ② | <i>Spherical loading head.</i> | Testa di carico sferica. |
|                              | CACCEM42 | ③ | <i>Knuckle joints.</i>         | Teste a snodo sferico    |



## OPZIONI

Da acquistare separatamente

## OPTIONS

To be purchased separately

|   | CODE            | <sup>(2)</sup> OPZIONE   | <sup>(2)</sup> OPTION   |
|---|-----------------|--|---|
|  | <b>CMIL6MF</b>  | Uscita diretta connettore <b>MIL6M</b>   | <i>Direct output connector <b>MIL6M</b></i>   |
|  | <b>CMIL6FV5</b> | CONNETTORE <b>MIL6M</b> femmina 6 poli dritto completo di <b>CAVO</b> PVC schermato lunghezza 5 m. | <i>Female 6 poles straight <b>MIL6M</b> CONNECTOR complete PVC CABLE, shielded, length 5 m.</i> |

|  | CODE              | <sup>(3)</sup> OPZIONE  | <sup>(3)</sup> OPTION  |
|--|-------------------|---|--|
|   | <b>CONNM12MF</b>  | Uscita diretta connettore <b>M12</b>  | <i>Direct output connector <b>M12</b></i>  |
|  | <b>CONNM12FV5</b> | CONNETTORE <b>M12x1</b> femmina 5 poli dritto completo di <b>CAVO</b> PVC costampato schermato lunghezza 3 m. | <i>Female 5 poles straight <b>M12x1</b> CONNECTOR complete PVC molded CABLE, shielded, length 3 m.</i> |

|   |            |   |   |
|---|------------|---|---|
|  | <b>CRT</b> | Rapporto di taratura.<br>Compressione o Trazione. | <i>Calibration Report.<br/>Compression or Tension</i> |
|---|------------|---|---|

## Collegamenti Elettrici

## Electrical Connections

**USCITA STANDARD:** cavo schermato PVC 105°C, Ø 5.2 mm a 4x Ø 0.35mm<sup>2</sup> conduttori stagnati. Schermo collegato al corpo del trasduttore.

**STANDARD OUTPUT:** PVC 105°C shielded cable, Ø 5.2mm with 4x Ø 0.35mm<sup>2</sup> tinned conductors. Shield connected to the body of the transducer.

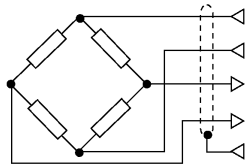
| Load cell   | OUTPUT       | CABLE  | CAVO    | MIL6M <sup>(2)</sup><br>(optional) | M12 <sup>(3)</sup><br>(optional) |
|---|--------------|--------|---------|------------------------------------|----------------------------------|
|  | EXCITATION + | Red    | Rosso   | A                                  | 1                                |
|   | EXCITATION - | Black  | Nero    | B                                  | 3                                |
|   | OUTPUT +     | White  | Bianco  | D                                  | 2                                |
|   | OUTPUT -     | Yellow | Giallo  | C                                  | 4                                |
|   | -----        | Shield | Schermo | F                                  | 5                                |

**AEP** transducers



Dasa-Rägister  
EN ISO 9001:2015  
IQ 1100-01



LAT N° 093  
**Calibration Centre**  
The products are NOT  
covered by accreditation



**Production Quality Assurance Certified n°**  
TÜV CY 17 ATEX 0205891 Q

41126 Cognento (MODENA) Italy Via Bottego 33/A Tel: +39-(0)59-346441 Fax: +39-(0)59-346437 E-mail: aep@aep.it

Al fine di migliorare le prestazioni tecniche del prodotto, la società si riserva di apportare variazioni senza preavviso.  
In order to improve the technical performances of the product, the company reserves the right to make any change without notice.